

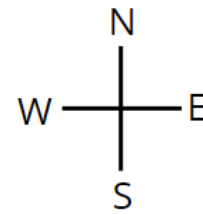

# AgSmart

presented by **AgExpert** 



Olds College Campus



### OUTDOOR BOOTHS

- 300 - Kubota Canada
- 302 - Croptimistic Technology Inc
- 303 - ALPINE
- 304 - Bangas Equipment
- 305 - Thunderstruck Ag
- 307 - Point Forward Solutions
- 308 - Findoor Industrial
- 309 - Solar YYC

- 310 - Ag Business & Crop Inc
- 312 - Jakoda Canada
- 313 - Kinetic Ag
- 314 - Alberta Wheat
- 316 - Quantum Genetix
- 317 - Climate Fieldview
- 320 - FCDC
- 321 - Olds College Smart Farm
- 322 - Noble Equipment

- 326 - TELUS Agriculture
- 328 - TreadRight
- 329 - SoilOptix
- 333 - Clean Seed
- 334 - Raven Industries
- 335 - OneCup AI
- 338 - ON HOLD
- 339 - TC Energy

- 341 - Landview Drones
- 345 - Advanced Ag

### DEMO PLOTS

- 101 - Croplands
- 102 - Olds College (Sensor Clusters)
- 103 - Rangeward Inc.
- 104/105 - Vantage Canada

# AgSmart Exhibit Tent

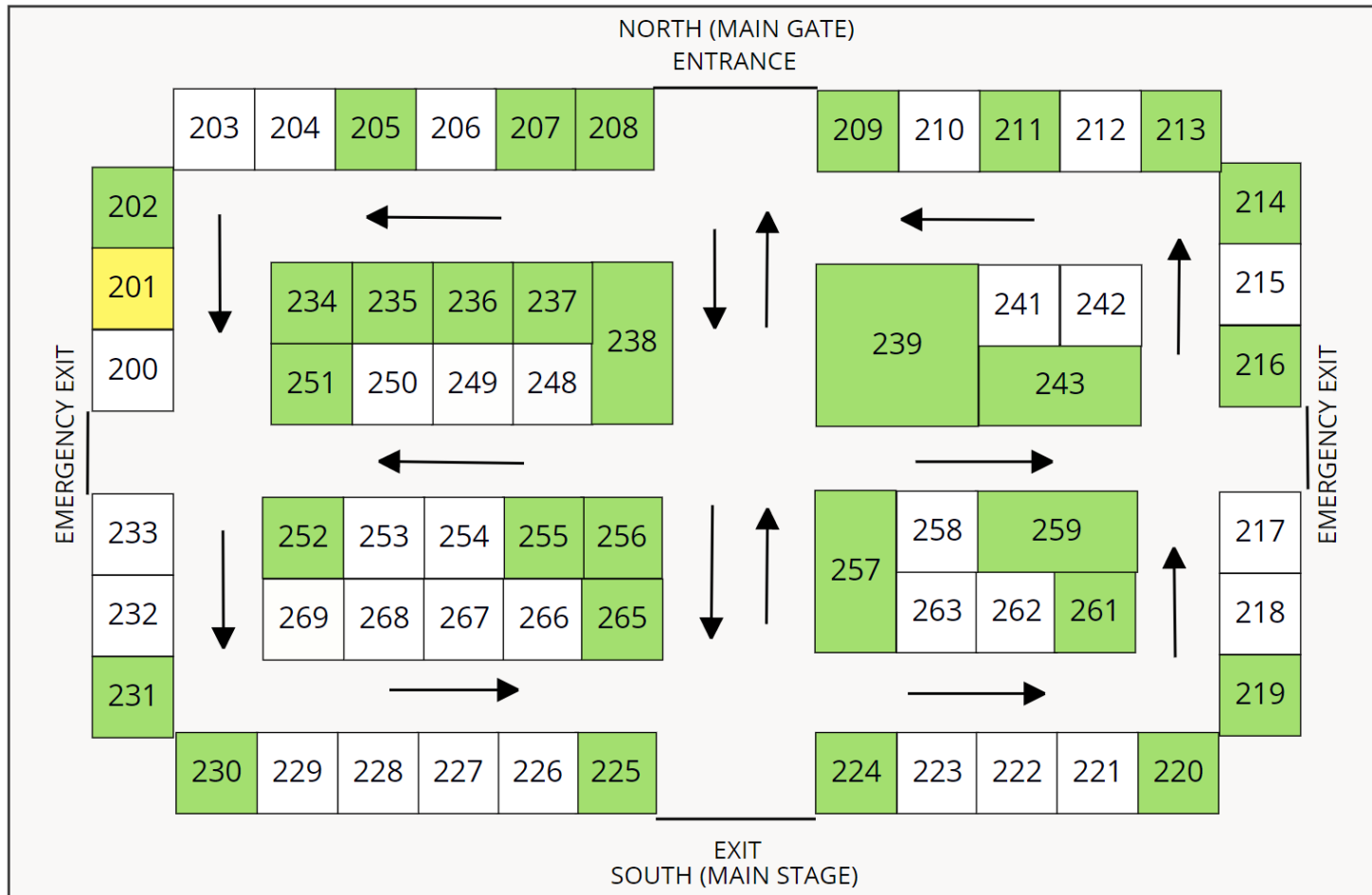

## INDOOR BOOTHS

- |                       |                            |                          |                                       |
|-----------------------|----------------------------|--------------------------|---------------------------------------|
| 201 - HOLD            | 213 - viterra              | 231 - Scotiabank         | 251 - Atom-Jet Industries             |
| 202 - CARIN           | 214 - Vantage Canada       | 234 - GrainViz           | 252 - Clews Management                |
| 205 - Analytika       | 216 - Daam Galvanizing Inc | 235 - AFSC               | 255 - Livestock Gentec                |
| 207 - Grain Discovery | 219 - Flokk Systems Inc    | 236 - TEKTELIC           | 256 - Bushel Plus                     |
| 208 - Annelida        | 220 - 20/20 Seed Labs      | 237 - SGS Biovision      | 257 - AgExpert                        |
| 209 - sick Sensors    | 224 - FarmCash             | 238 - TELUS Agriculture  | 259 - Powerlift Hydraulic Doors       |
| 211 - AGRA-GPS        | 225 - Top Grade Ag         | 239 - ATB                | 261 - Olds Fertilizer & Agri Services |
|                       | 230 - Schergain            | 243 - Real Estate Centre | 265 - Ag Exchange Group               |